

### Working Conditions

1. The ambient temperature: upper limit +40°C, lower limit -40 °C;
2. Altitude: no more than 3000m;
3. Wind speed: not more than 35m/s;
4. Earthquake intensity: do not exceed 8 degree;
5. Pollution level: no more than III;
6. No severe vibration, no corrosive gas, no fire, no explosion danger place.

### Outline and Mounting Dimensions

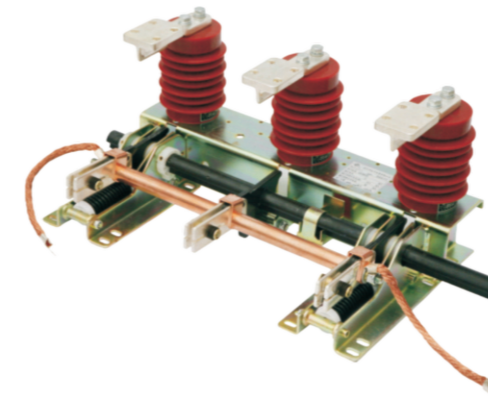
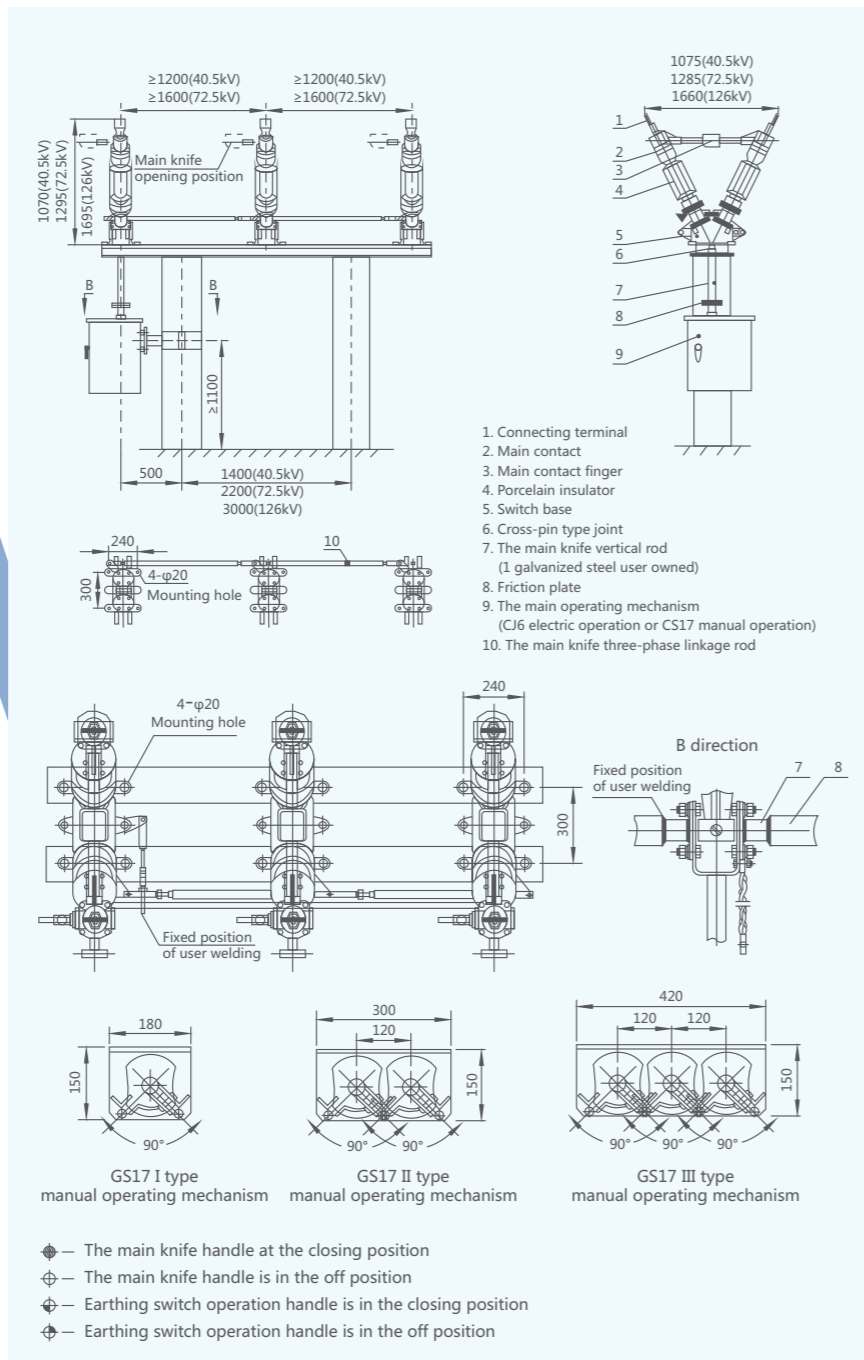

### Model and Meaning

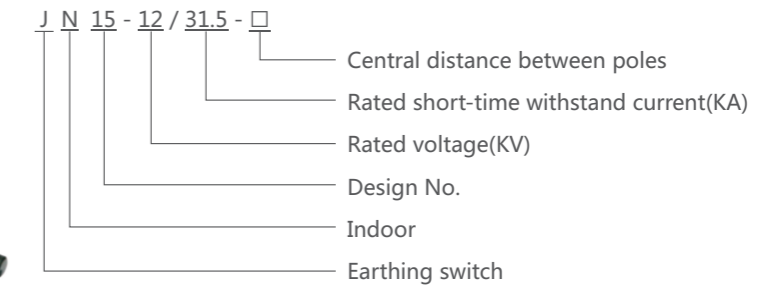

### General Introduction

JN15-12/31.5 series indoor earthing switch is a new design and improved product of our company according to the ES1 type, suitable with electric power system with 3-12KV, Three-phase, AC 50(60)Hz, support with various kinds of HV switchgear and as earthing protection. It is manufactured comply with GB1985-2004 and IEC129 standard.

### Working Conditions

1. Ambient temperature: -10~+40°C
2. Altitude: ≤1000m (sensor height:140mm)
3. Relative humidity: Day average relative humidity ≤95%  
Month average relative humidity ≤90%
4. Earthquake intensity: ≤8degree
5. Dirtiness degree: II

### Technical Specification

Item	Units	Data	
Rated voltage	kV	12	
Rated short time withstand current	kA	31.5	
Rated short circuit withstand time	s	4	
Rated short circuit making current	kA	80	
Rated peak withstand current	kA	80	
Rated insulation level	1min power frequency withstand voltage	kV	42
	Lightning Impulse withstand voltage	kV	75
Mechanism life	time	2000	

**JN15-12/31.5 earthing switch(ES-10/31.5) Outline and Mounting Dimension**

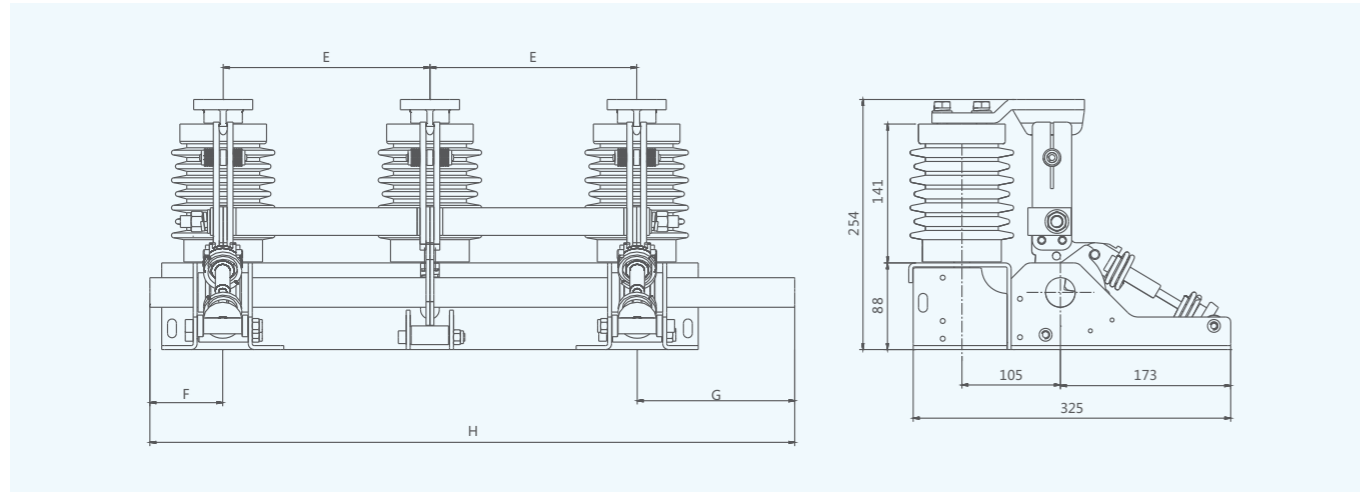

**Copper terminal block**

**Hole location diagram**

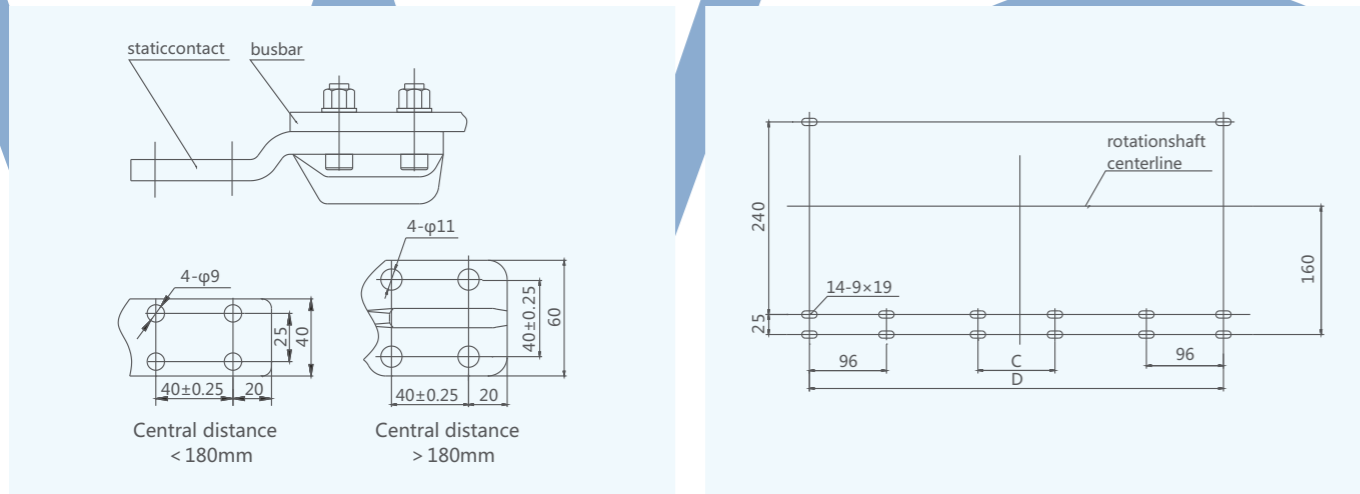

(Unit:mm)

Model	E	F	G	H	D	C
JN15-12/31.5-165	165	75	160	565	426	
JN15-12/31.5-180	180	75	160	595	456	
JN15-12/31.5-200	200	50	160	635	496	
JN15-12/31.5-210	210	50	185	655	516	
JN15-12/31.5-220	220	75	185	675	536	
JN15-12/31.5-230	230	75	185	695	556	96
JN15-12/31.5-250	250	75	185	735	596	96
JN15-12/31.5-275	275	75	210	810	646	96

**Order notes:**

1. Indicate product specification, central distance between poles, if need the electric display device(type of the display) or not.
2. Need lengthen the soft link or not(normal L=250mm).
3. Please consult with our company if you have any special request.

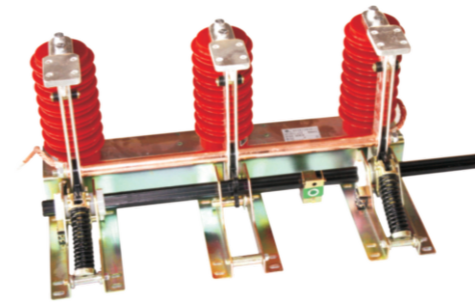

**Model and Meaning**

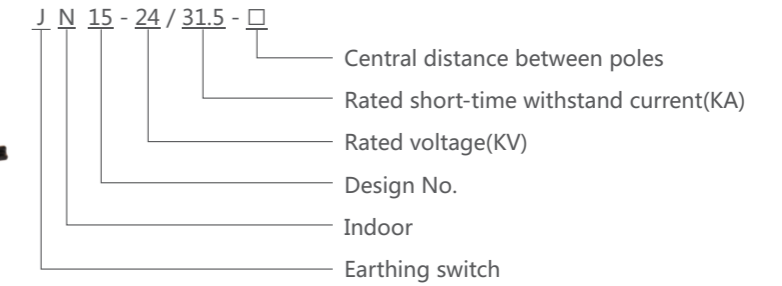

**General Introduction**

JN15-24/31.5 series indoor earthing switch is a new design and improved product of our company according to the JN15 type, (the installing size without any change), suitable with electric power system with 20-24KV, Three-phase, AC 50(60) Hz, support with various kinds of HV switchgear and as earthing protection. It is manufactured comply with GB1985-2004 and IEC129 standard.

**Working Conditions**

1. Ambient temperature:-10~+40°C
2. Altitude: ≤2000m
3. Relative humidity: Day average relative humidity ≤95%  
Month average relative humidity ≤90%
4. Earthquake intensity: ≤8degree
5. Class of pollution: II

**Technical Specification**

Item	Units	Data	
Rated voltage	kV	24	
Rated short time withstand current	kA	31.5	
Rated short circuit withstand time	s	4	
Rated short circuit making current	kA	80	
Rated peak withstand current	kA	80	
Rated insulation level	1min power frequency withstand voltage	kV	65
	Lightning Impulse withstand voltage	kV	95
Mechanism life	time	2000	

**Installation drawing**

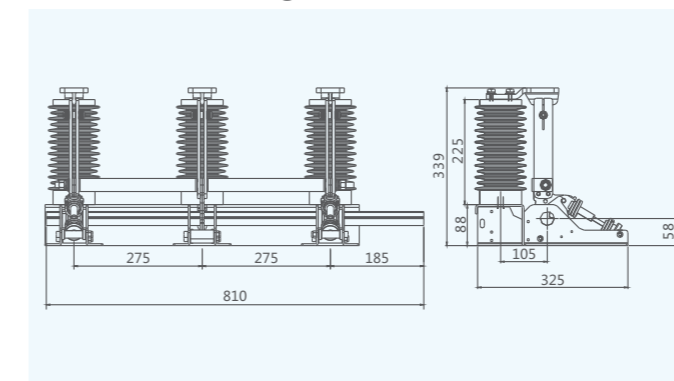

**Hole location diagram**

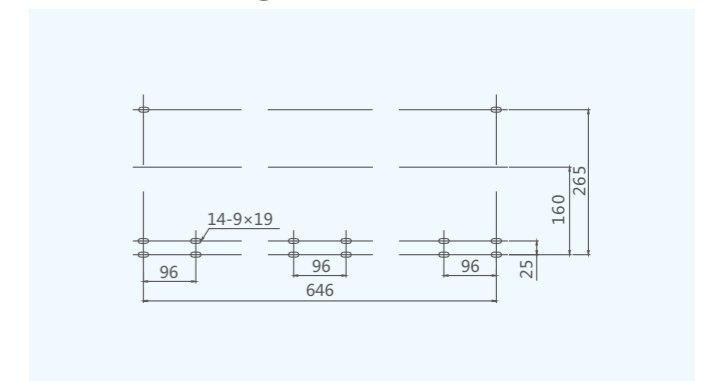

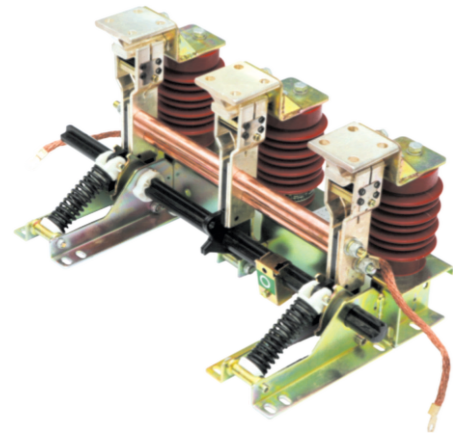

**Model and Meaning**

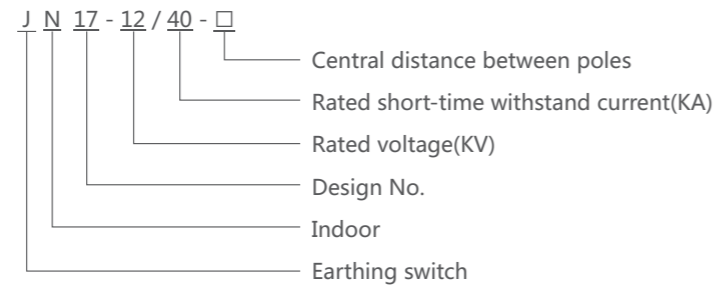

**General Introduction**

JN17-12/40 (old type is JN15-12/40) series indoor high voltage earthing switch is a new design and improved product of our company according to the ES1 type, the structure is assembled, suitable with electric power system with 3-10KV, Three-phase, AC 50(60)Hz, support with various kinds of HV switchgear and as earthing protection. It is manufactured comply with GB1985-2004 and IEC129 standard.

**Working Conditions**

1. Ambient temperature: -10~+40°C
2. Altitude: ≤1000m (sensor height:140mm)
3. Relative humidity: Day average relative humidity ≤95%  
Month average relative humidity ≤90%
4. Earthquake intensity: ≤8degree
5. Dirtiness degree: II

**Technical Specification**

Item	Units	Data
Rated voltage	kV	12
Rated short time withstand current	kA	40
Rated short circuit withstand time	s	4
Rated short circuit making current	kA	100
Rated peak withstand current	kA	100
Rated insulation level	1min power frequency withstand voltage	kV 42
	Lightning Impulse withstand voltage	kV 75
Mechanism life	time	2000

**JN17-12/40 Earthing switch outline and installation dimension**

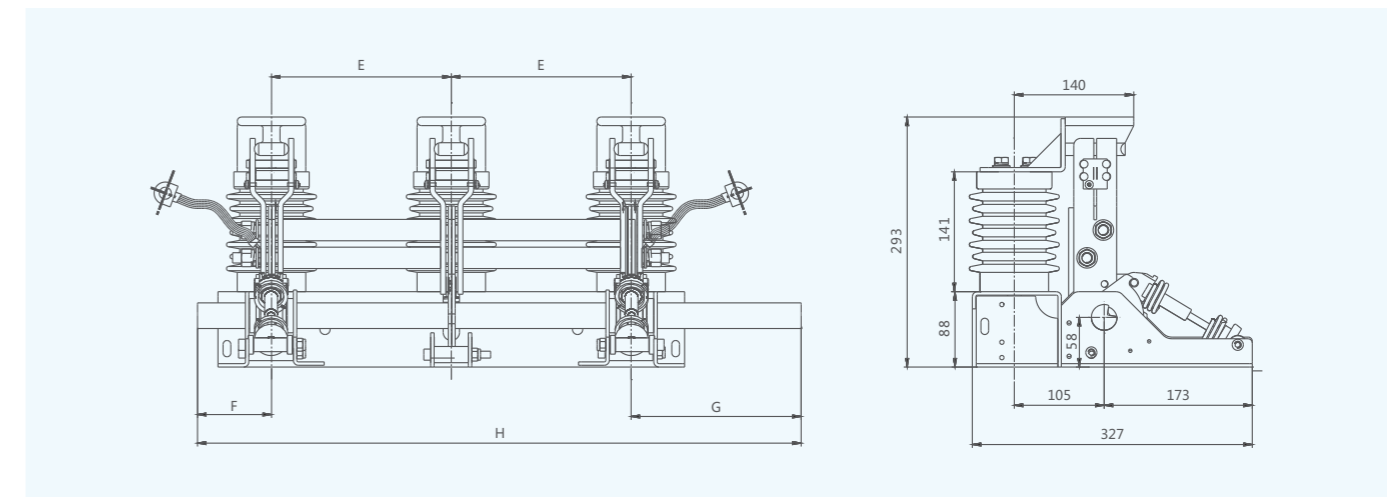

**Copper terminal block**

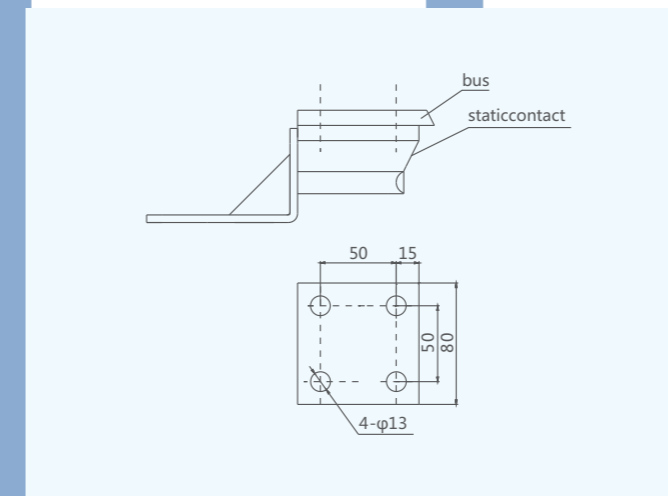

**Hole location diagram**

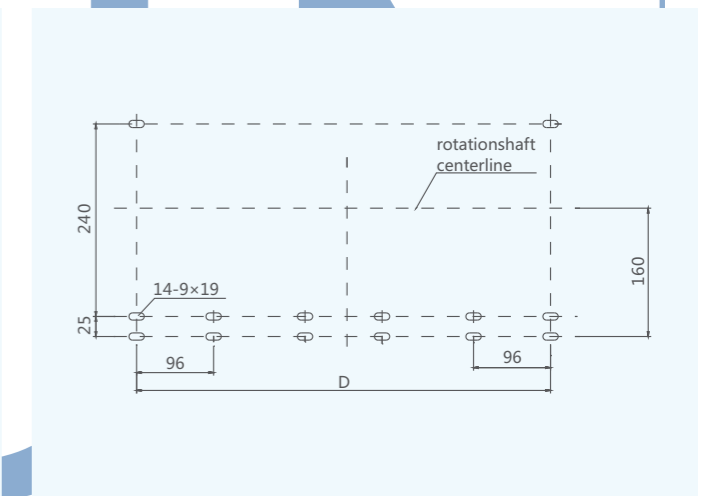

Specification	E	F	G	H	D
JN17-12/40-210	210	50	185	655	516
JN17-12/40-220	220	50	185	675	536
JN17-12/40-230	230	50	185	695	556
JN17-12/40-250	250	50	185	735	596
JN17-12/40-275	275	50	210	810	646

**Order notes:**

1. Indicate product specification, central distance between poles, if need the electric display device(type of the display) or not.
2. Need lengthen the soft link or not(normal L=250mm)
3. Please consult with our company if you have any special request.

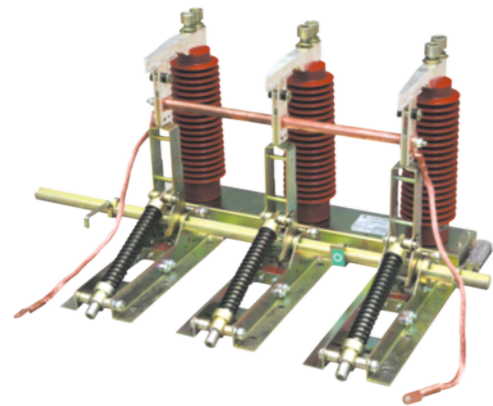

### Model and Meaning

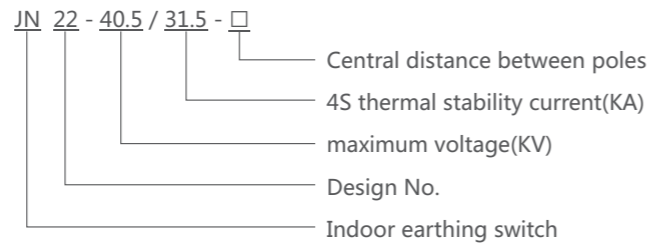

### General Introduction

JN22-40.5/31.5 series indoor HV earthing switch is researched and developed by XI'AN HV Electric research organization, with advanced design and steady performance, simple structures, simple mounting and adjustment, suitable of electric power system with 40.5KV, Three-phase, AC 50Hz.. Support with KYN□-40.5 and other various kinds of HV switchgear and as earthing protection. It is manufactured comply with GB1985-2004 and IEC129 standard.

### Working Conditions

1. Ambient temperature:-10~+40°C
2. Altitude: ≤1000m
3. Relative humidity: Day average relative humidity ≤95%  
Month average relative humidity ≤90%
4. Earthquake intensity: ≤8degree
5. Applicable in the place without corrosive, flammable gas and water place
6. With no frequently intense vibrant place around.

### Technical Specification

Item	Units	Data	
Rated voltage	kV	35	
Maximum voltage	kV	40.5	
Rated short time withstand current	kA	31.5	
Rated short circuit withstand time	s	4	
Rated short circuit making current	kA	80	
Rated peak withstand current	kA	80	
Rated insulation level	1min power frequency withstand voltage	kV	95
	Lightning Impulse withstand voltage	kV	185
Central distance between poles	mm	300; 350; 400	

### Outline and Mounting Dimensions

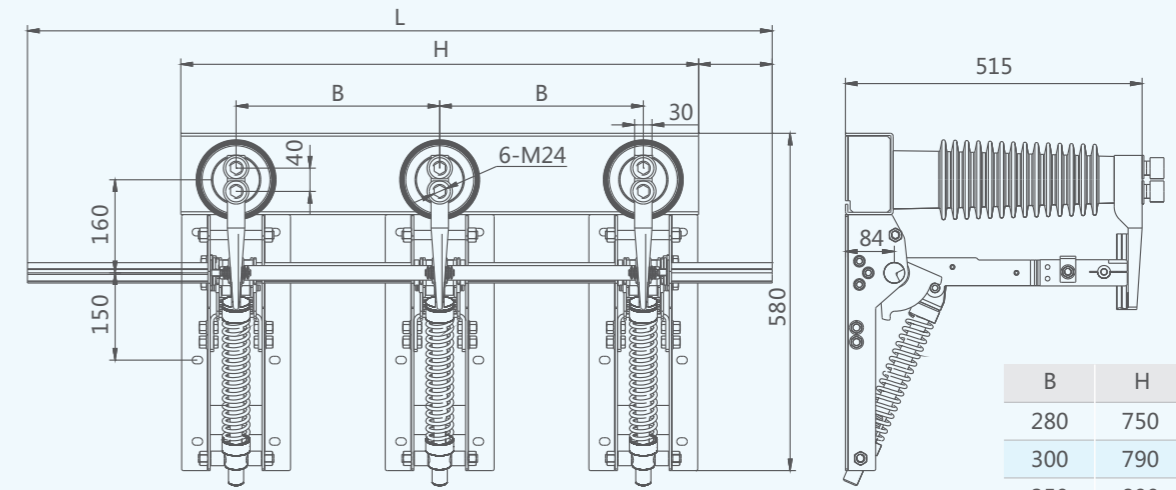

B	H	L
280	750	1180
300	790	1180
350	890	1280
400	990	1374

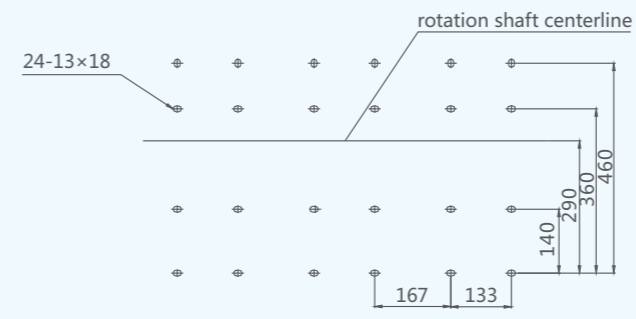

B	H
280	750
300	790
350	890
400	990

### Cabinet backards

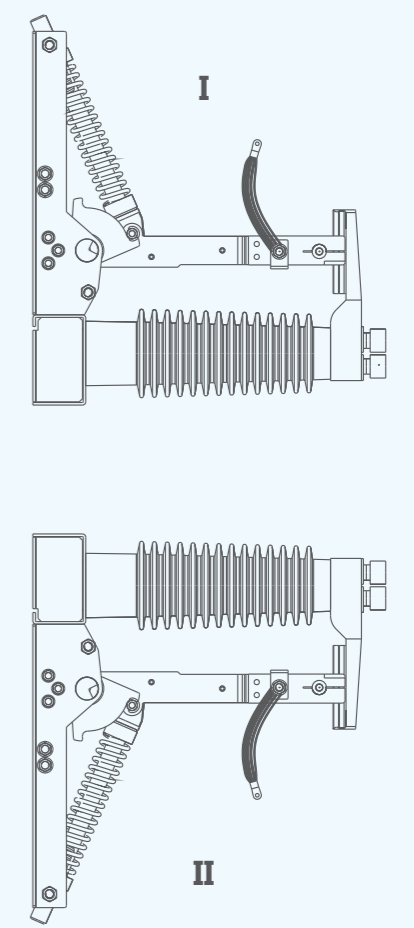

### Order Notes

1. Indicate product specification, rated voltage, thermal stability current, central distance between poles.
2. If need shaft operating mechanism, indicate right operation mechanism or left operation mechanism according to the operation position shows in the drawing above.
3. If need sensors with electric display device, please indicate the display type.
4. Please consult with our company if you have any special request.

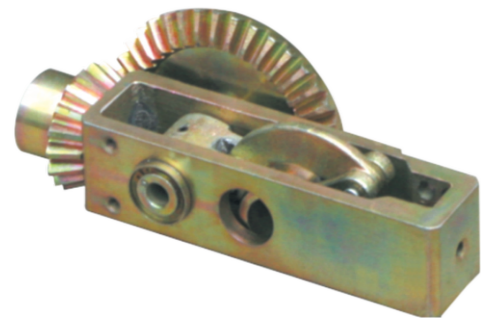

**General Introduction**

1. CL-40.5 type bevel gear mechanism is used for manual control operation with JN22-40.5/31.5 indoor HV earthing switch. It comply with KYN□-40.5 switchgear cabinet and other various types switchgear.
2. Operating shaft's rotation angle is 270°: 90°(open-close)
3. The operation mechanism as the drawing shows is right operation, the closing centerline is the rotation line of operation mechanism. If need left operation, please ask the factory to change the direction, and user can install the bevel gear symmetrically on the left side according to the drawing above.
4. As the opening centerline is rotation line of operating mechanism, user can install the main shaft of earthing switch right operation or left operation. Installation according to the drawing shows above is left operation, symmetrically is right operation.

**Order Notes**

1. Indicate the operating method of mechanism operation shaft and operating method of earthing switch shaft right or left.
2. Please consult with our company if you have special request.

**Outline and Mounting Dimensions**

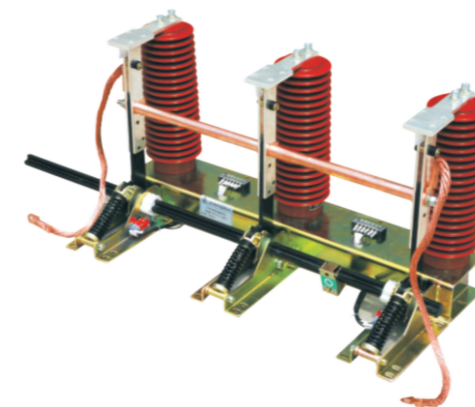
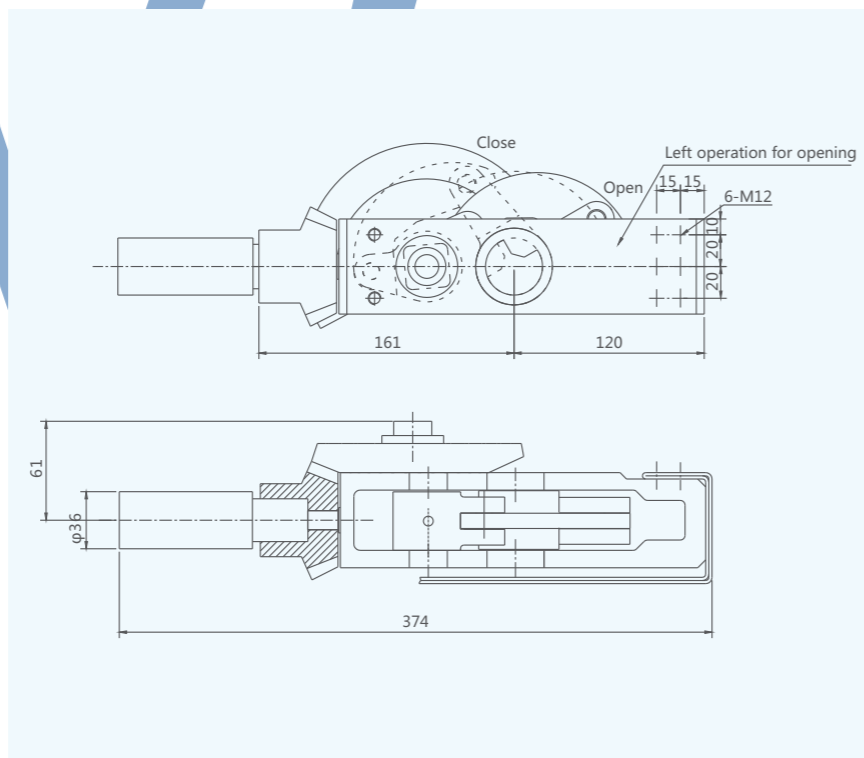

**Model and Meaing**

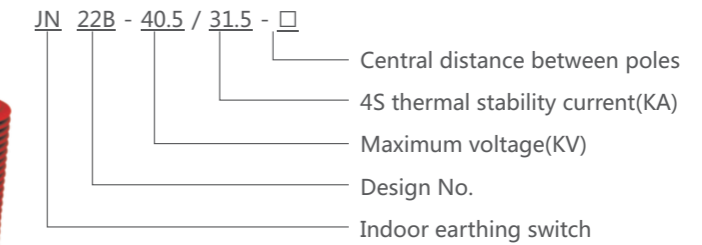

**General Introduction**

JN22B-40.5/31.5 series indoor HV earthing switch is researched and developed by our company based on original JN15 type, supporting with electric power system 40.5KV, AC 50Hz, match KYN□-40.5 and other various kinds of HV switchgear and as earthing protection. It is manufactured comply with GB1985-2004 and IEC129 standard.

**Working Conditions**

1. Ambient temperature:-10~+40°C
2. Altitude: ≤1000m
3. Relative humidity: Day average relative humidity ≤95%  
Month average relative humidity ≤90%
4. Earthquake intensity: ≤8degree
5. Applicable in the place without corrosive, flammable gas and water place
6. With no frequently intense vibrant place around.

**Outline and Mounting Dimensions**

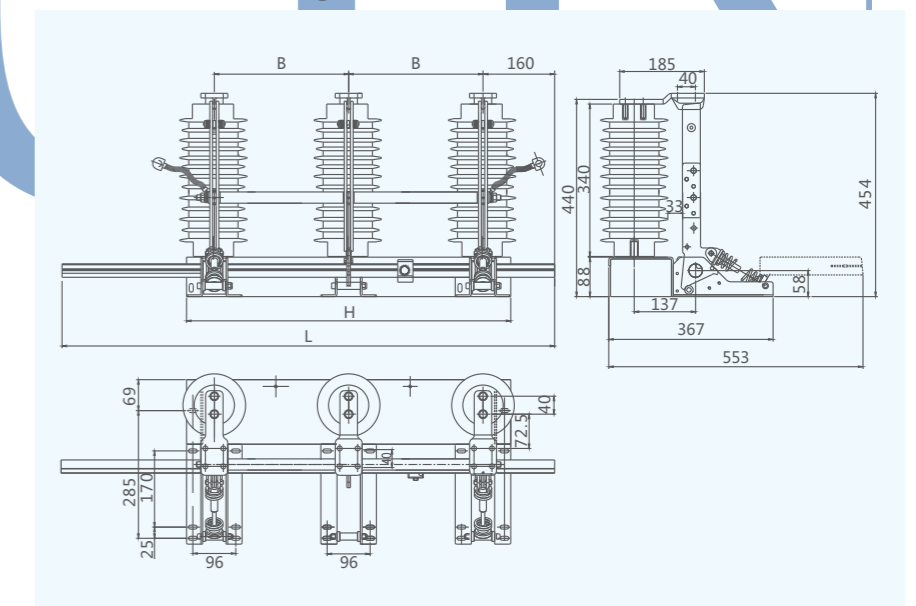

B	H	B
280	750	1180
300	790	1180
350	890	1280
400	990	1374